

Dobradiça Caneco 35 com Amortecimento Integrado

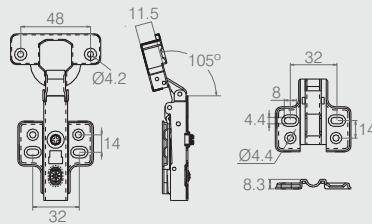

- Material: Dobradiça e calço em aço
- Acabamento: Niquelado
- Fixação: Parafusos
- Encaixe através de "clip"
- Regulagem tridimensional
- Fechamento com amortecimento incluso
- Ângulo de abertura 105°

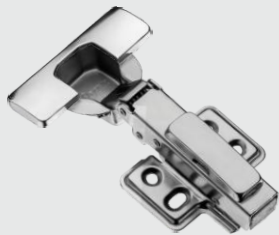
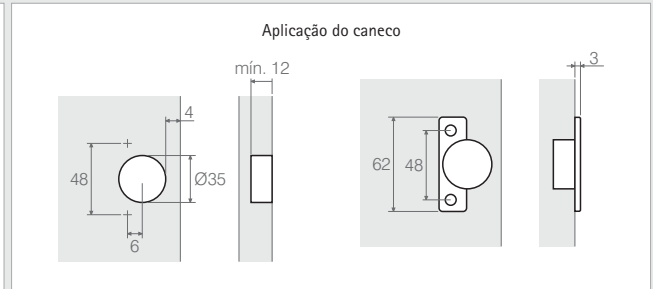
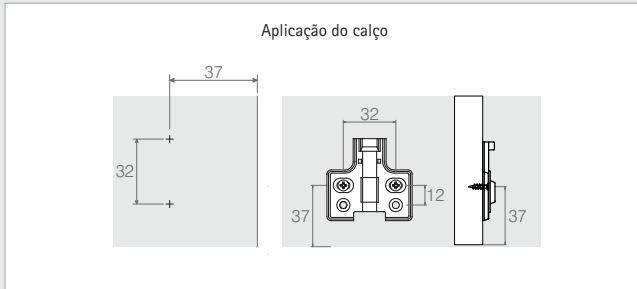
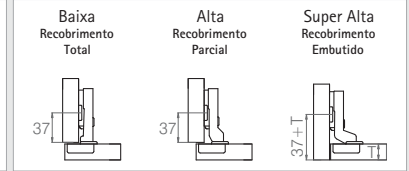
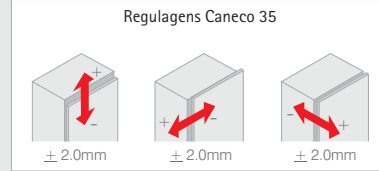

**Dobradiça Caneco 35
Colo Baixo com Calço 0**

07.05.457
com amortecimento

- Material: Aço
- Acabamento: Níquel (421)

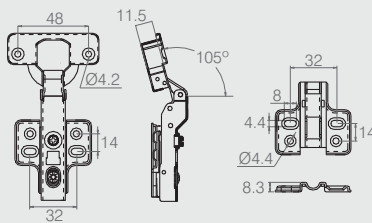

**Dobradiça Caneco 35
Colo Alto com Calço 0**

07.05.458
com amortecimento

- Material: Aço
- Acabamento: Níquel (421)

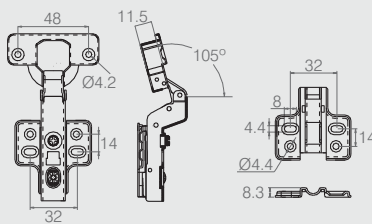

**Dobradiça Caneco 35
Colo Super Alto com Calço 0**

07.05.459
com amortecimento

- Material: Aço
- Acabamento: Níquel (421)