

Dobradiça Caneco 26

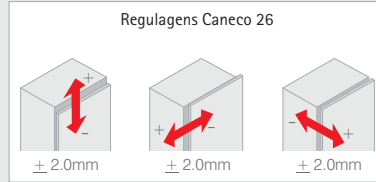

- Material: Dobradiça e calço em aço
- Acabamento: Zinco Branco/Niquelado
- Fixação: Parafusos
- Regulagem: Tridimensional
- Ângulo de abertura: 95°



Referência de número de dobradiças por porta

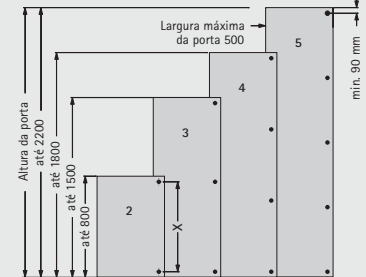

Valores de referência para chapas de 15mm de espessura e densidade 750kg/m<sup>3</sup> podendo variar conforme instalação no móvel.

Forma de Montagem - Dobradiças 26 e Calços

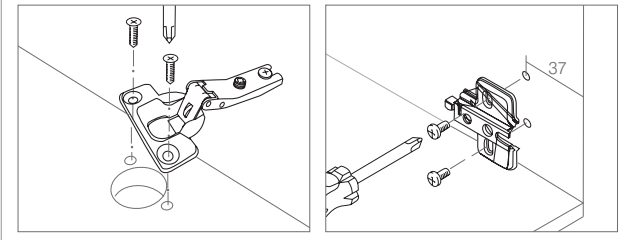

Aplicação do caneco

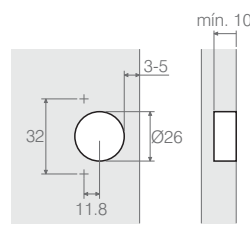

Medidas do caneco

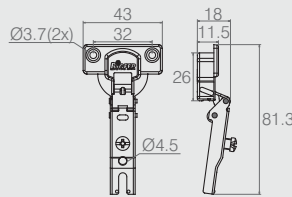
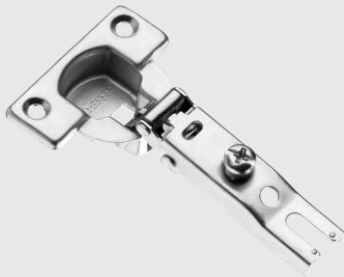
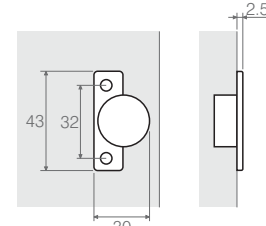

**Dobradiça Caneco 26**  
**Colo Baixo**

**07.05.301**  
com mola

**07.05.415**  
sem mola

- Material: Aço
- Acabamento: Zinco Branco (411)

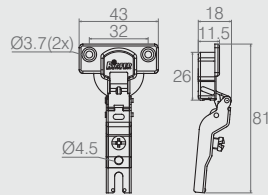
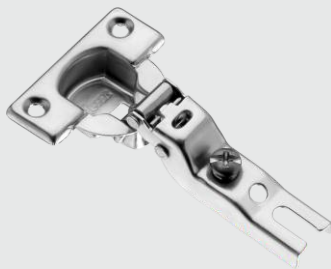

**Dobradiça Caneco 26**  
**Colo Alto**

**07.05.302**  
com mola

**07.05.416**  
sem mola

- Material: Aço
- Acabamento: Zinco Branco (411)

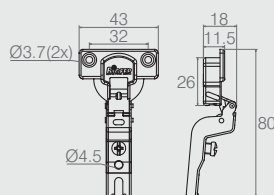
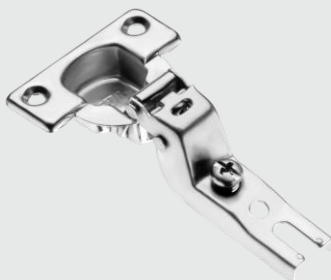

**Dobradiça Caneco 26**  
**Colo Super Alto**

**07.05.305**  
com mola

**07.05.448**  
sem mola

- Material: Aço
- Acabamento: Zinco Branco (411)