

Suporte para Cabideiro Oblongo Tabela

Código	A	B	C
04.02.036	27.5	64	46.5
04.02.030	16.5	51	34

- Material: Polímero
- Acabamento: conforme tabela de cores

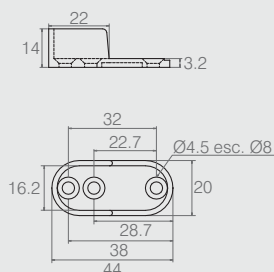

Suporte Cabideiro 20x44

04.02.080

- Material: Zamac
- Acabamentos: Níquel (421) e Zinco Branco (411)

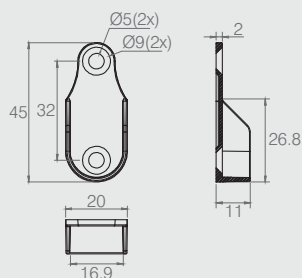

Suporte para Cabideiro Oblongo

04.02.235

- Material: Zamac
- Acabamentos: Níquelado (421) e Zinco Branco (411)

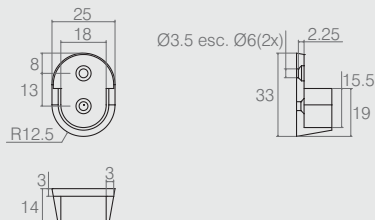

Suporte Cabideiro

04.02.171

- Material: Polímero
- Acabamento: Alumínio (001)

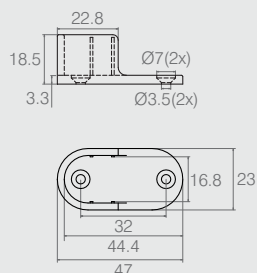

Suporte Cabideiro Oblongo

04.02.054

- Material: Polímero
- Acabamento: conforme tabela de cores