

Arruela 3 Furos
09.05.086

- Material: Aço 1.9
- Acabamento: Zinco Branco (411)

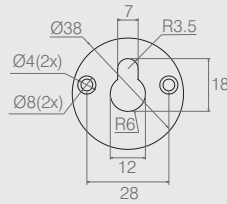
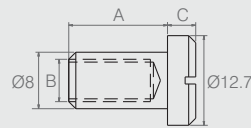

Arruela 2 Furos
09.05.143

- Material: Aço 1.9
- Acabamento: Zinco Branco (411)

Porca de Parafuso União Fenda Simples
Tabela

Código	A	B	C
09.03.165	11	1/4"x9	2
09.03.070	14	1/4"x11	3.5
09.03.042	11	M6x8.5	2
09.03.008	11	3/16"x9	2

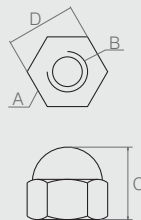
- Material: Aço
- Acabamentos: Zinco Branco (411) e Sem Acabamento (901)

Porca Cega Sextavada
Tabela

Código	A	B	C	D
09.03.005	3/8"	1/4"x6	9	9.6
09.03.045	3/8"	1/4"x7	11	9.6
09.03.002	7/16"	1/4"x7	11	11.1
09.03.011	7/16"	1/4"x10	13	11.1
09.03.003	1/2"	5/16"x8	12	12.7
09.03.012	5/16"	3/16"x6	8	7.9

- Material: Aço
- Acabamentos: Zinco Branco (411) e Sem Acabamento (901)

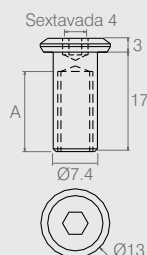
Porca Allen
Tabela

Código	A
09.03.081	M6x10
09.03.214	1/4"x10

- Material: Aço
- Acabamentos: Zinco Branco (411), Zinco Preto (412) e Zinco Amarelo (413)