

Cantoneira

04.08.096

- Material: Aço 1.2
- Acabamento: Zinco Branco (411)

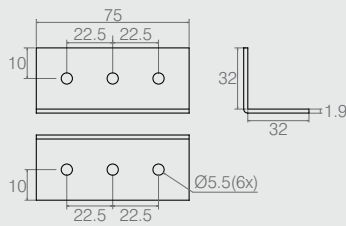
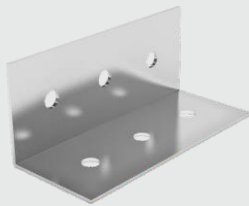

**Cantoneira 32x32x75
Furo Central**

08.02.231

- Material: Aço 1.9
- Acabamento: Zinco Branco (411)

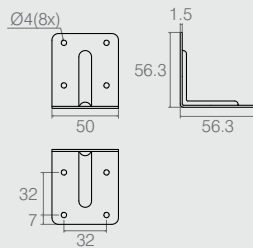

Cantoneira 56x56mm

08.02.230

- Material: Aço 1.5
- Acabamento: Zinco Branco (411)

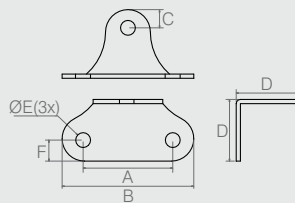

Cantoneira de Fixação

Tabela

Código	A	B	C	D	ØE	F
04.02.032	32	47	6.5	22	5.3	7.5
04.02.093	32	47	6.5	22	5.3 esc. 8.3	7.5
04.08.085	22	40	7	21.5	5	7

- Material: Aço 1.5
- Acabamentos: Zinco Branco (411) e Pintura Epóxi Branco (601)

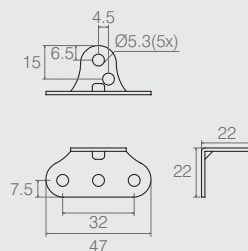

Cantoneira de Fixação

04.02.256

- Material: Aço 1.5
- Acabamento: Zinco Branco (411)